

Specifications

Displacement	= 81,08 cm ³ /rev	Pump rotation	= Bidirectional
Max. continuous pressure (100%)	= 205 bar	Inlet pressure	= 0,3 ÷ 2 bar
Max. intermittent pressure (20sec. max)	= 225 bar	Oil filtering:	= > 200 bar: 10 µm / < 200 bar: 25 µm
Max. peak pressure (6sec. max)	= 230 bar	Working temperature	= -15°C +100°C
Max. continuous speed	= 1900 rpm	Viscosity index suggested	= VI > 100
Max. intermittent speed	= 2500 rpm	Max kinematic viscosity suggested at the start-up	= VG= 750 cSt
Min. speed	= 300 rpm	Optimale kinematic viscosity	= VG= 10 cSt ÷ 100 cSt
IN ISO 228	= G 1	Fluid	= Mineral or synthetic compatible with the following seals: NBR, FKM, FPM, Nylon
OUT ISO 228	= G 1		
Weight	= 15,8 Kg		

Verify that pump is, at least, 100 mm under the minimum level of the tank.
Before starting the pump bleed the air.

Kinematic viscosity suggested

Average ambient temp. (°C)	VG (cSt = mm ² /s)
< -10	22
-10÷10	32
10÷35	46
> 35	68

Related documentation

Mounting instructions: PUM-0017

Torque - Pressure characteristics

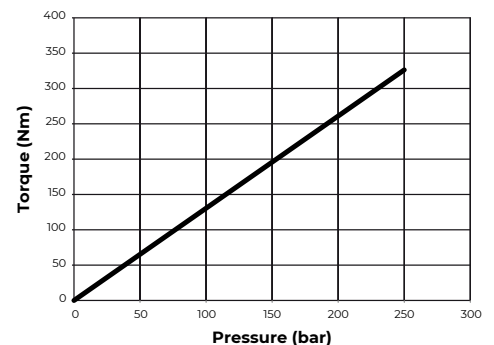

Spare parts

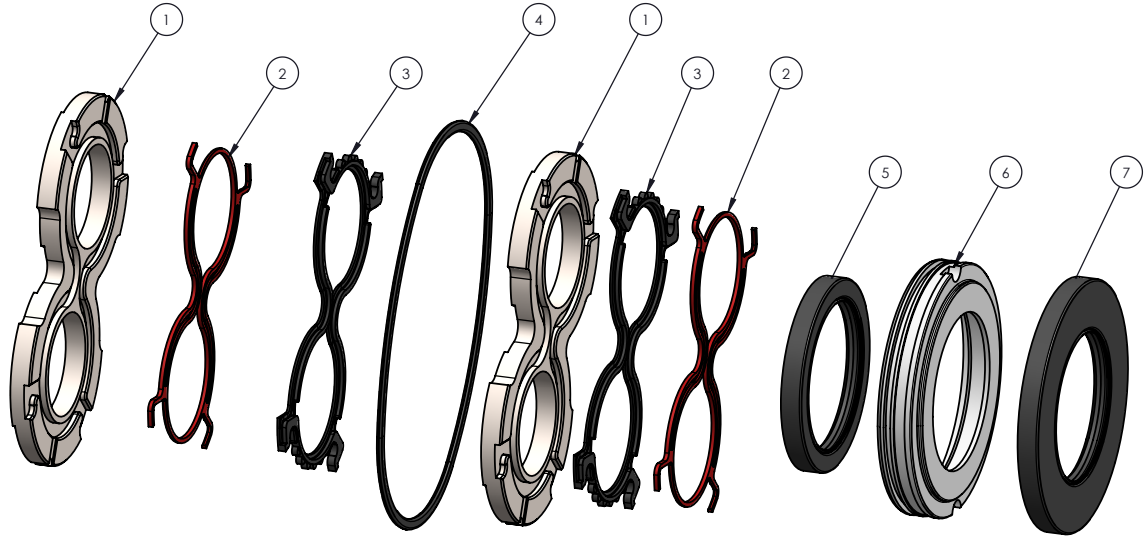

N°	Part.no	Description	Qty.
1	02411002	Thrust plate	2
2		Back-up ring	2
3		Thrust plate seal	2
4		O-ring	1
5		Oil seal 55x42x6	1
6		Oil seal flange	1
7		Oil seal 72x42x6	1

N°	Part. no	Description
2	02410032	Seal kit
3		
4		
5		
6		
7		

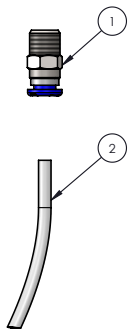

N°	Part. no	Description
1	02412495	Leakage indicator kit
2		